

Smart Wireless Keyboard (VG-KBD1500)

Accessories

- User manual
- Batteries (AA x 2)
- Warranty card

Update TV

▲ To use Smart Wireless Keyboard, the TV should be updated by USB or Online.

Using USB

1. Download the latest TV software at www.samsung.com and extract it to the USB using your PC.
2. Turn on the TV, and then insert the USB into the USB port of the TV.
3. In the TV's menu, go to **Support** → **Software Update** and select "**By USB**".
4. The TV upgrades the software, turns off, and then turns on automatically.

On screen menu

1. Connect your TV to internet network.
2. In the TV's menu, go to **Support** → **Software Update** and select "**Online**".
3. If there is a download available, the Download pop-up appears with a progress bar and the download starts.
4. When the download is complete and the Upgrade Query screen appears, select **Update Now**.
5. The TV upgrades the software, turns off, and then turns on automatically.

📖 For more detail information, refer to the e-Manual.

User manual

Use the wireless keyboard as a remote control as described below.

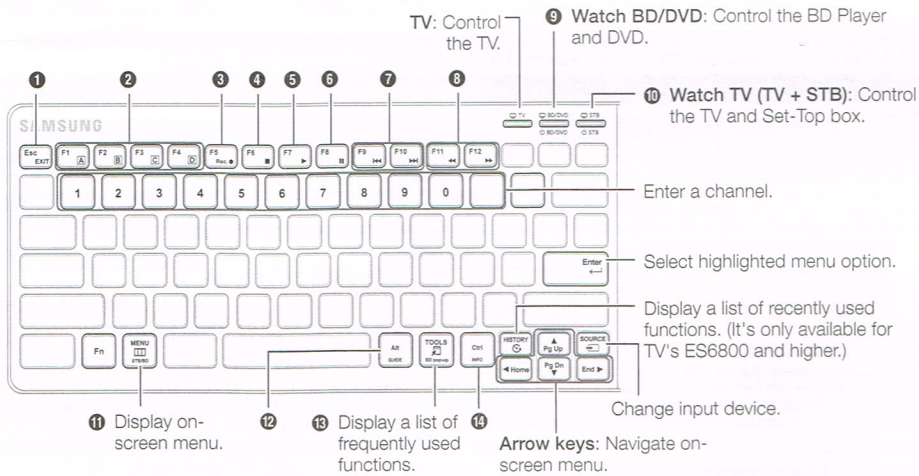

These keys below are available only with high-class models. Upgrade the TV to the latest firmware and set up the IR Blaster to use the keys.

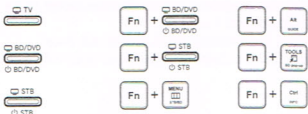

👉 Touchpad highlight mode

	Compatible Models
North America	LED ES7500 and higher / PDP E8000
The other countries	LED ES7000 and higher / PDP E8000

You can use the following functions by pressing the keys below with the **Fn** key.

To use the keys below, you should update your TV by USB or Online and set your IR Blaster.

1		Exit Menu	9		Turn the BD/DVD on or off.
3		Recording	10		Turn the STB on or off.
4		Stop	11		Display the STB or BD menu.
5		Play	12		Display the TV or STB Guide.
6		Pause	13		Display the BD pop-up.
7		Play the previous, next file	14		Display the detailed information.
8		Rewind, Fast forward			
1		Return Go to previous menu screen.	5		CH LIST Display list of available channels.
2		Color Use these keys, being guided by on-screen help.	6		Mute Turn sound off or on.
3		Smart Display list of available applications.	7		Volume Increase or decrease volume.
4		Source Change input device.	8		Channel Change channel up or down.

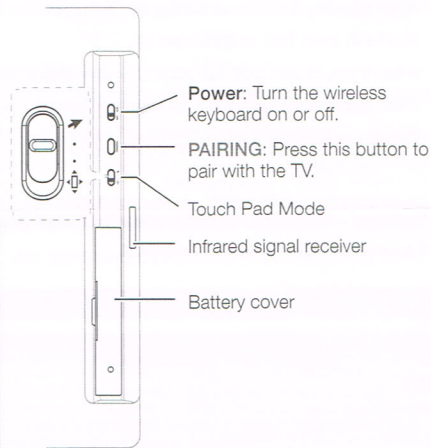
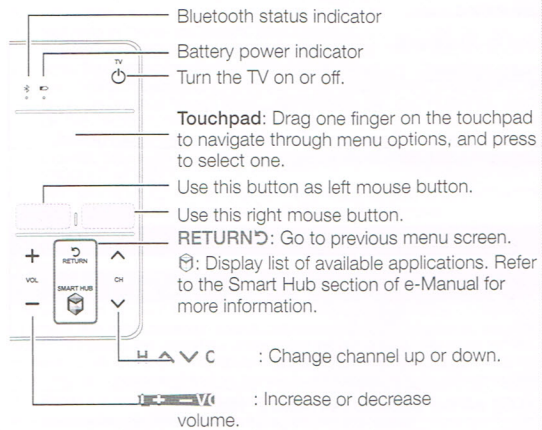

Switching the Touchpad

- **Pointer mode** : Rub a finger or thumb on the Touchpad to move the mouse pointer on the screen. Click the Touchpad to select a menu item.
- **Highlight mode** : Rub on the Touchpad to move the highlight bar on the screen. Click the Touchpad to select a menu item.

Inserting batteries

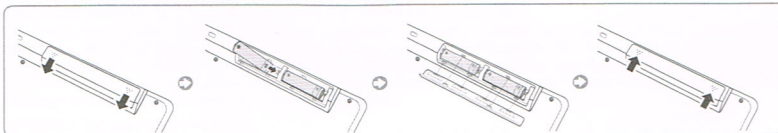

Pairing

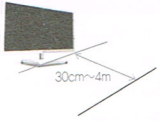

Initial Pairing

1. Turn on the TV.
2. Turn on the wireless keyboard, and then move it to the direction of your TV.
3. Press anykey except MENU, Ctrl, Alt or PAIRING button for 2 seconds, then indicators begin to blink alternately for 5 minutes while trying to pair with the TV.
4. indicators blink twice at the same time and stop blinking when pairing succeeds.

Manual Pairing

1. Turn on the TV.
2. Turn on the wireless keyboard, and then move it to the direction of your TV.
3. Press PAIRING button for 2 seconds, then indicators begin to blink alternately for 5 minutes while trying to pair with the TV.
4. indicators blink twice at the same time and stop blinking when pairing succeeds.

Indicators (,)

- **When inserting batteries or turning on:** Both indicators blink once at the same time.
 - **Bluetooth error:** Both indicators are on.
 - **When trying to pair:** Both indicators blink alternately every 0.5 second.
 - **Initial status:** Both indicators blink alternately every 0.5 second for 30 seconds.
 - **Change batteries:** When blinking battery power indicator, Change batteries.
- Changing the keyboard language is as follows. (Go to the Menu → System → Device Manager → Keyboard Settings → Keyboard Options menu to change language.)
- Some applications may not support.

Specification

Model	Smart Wireless Keyboard (VG-KBD1500)
Battery	AA x 2
Dimension (mm) (Length) x (Depth) x (Height)	317.0 x 9.6 x 123.8 mm
Weight	405g without batteries (AA battery: 45g)

Compatible Models

Korea	LED ES6350 and higher / PDP E550 and higher / Samsung mobiles (Android-based)
North America, Latin America	LED ES6500 and higher / PDP E550 and higher / Samsung mobiles (Android-based)
The other countries	LED ES6100 and higher / PDP E550 and higher / Samsung mobiles (Android-based)

- It may not be compatible according to the specifications of the device.

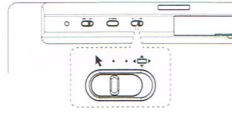
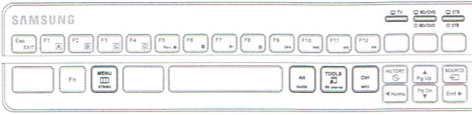

- Some of the keys might not be available depending on TV model.
- Upgrade the TV to the latest firmware and set up the IR Blaster to use the TV dedicated keys. Refer to the guide for details.

Compatible Models	
North America	LED ES7500 and higher / PDP E8000
The other countries	LED ES7000 and higher / PDP E8000